

The flexible camera-mount for Micro cameras

Instruction manual

Please read this instruction manual carefully before using this product and keep it for future reference.

Important safeguards

Please make sure to follow all instructions when you use the camera-mount.

This "Important safeguards" is provided to ensure proper operation of the product and will prevent you or others from personal injury or loss.

Please read carefully and keep the manual in a safe place for future reference. Review the following symbols so that you understand them before reading the rest of the manual.



Warning

Ignoring this warning and operating the system incorrectly subjects the user to possible risk of serious injury or death.



Caution

Ignoring this warning and operating the system incorrectly subjects the user to possible risk of injury or loss.

● Explanation of the Symbols Used



Name : Caution
Explanation : The user must follow or be exposed to danger. Nearby text and illustrations give further details.









Name : Prohibition
Explanation : The user must avoid these actions or be exposed to danger. Nearby text and illustrations give further details.



Name : Must follow
Explanation : The user must follow the instructions. Nearby text and illustrations give further details.

ELMO CO., LTD.

Warning

-  **Do not install the camera-mount in areas where salt erosion or corrosive gas is produced.**
The attachment part will be damaged and it may cause the camera to drop accidentally.
-  **Do not attach objects other than specified camera heads to the camera-mount.**
Insufficient support strength due to improper size of object may cause the camera to drop accidentally leading to injury to persons nearby or damage to the object.
-  **Tighten a locking screw firmly.**
Neglecting to do so may cause the camera to drop accidentally. In addition, loosely tightened screws may cause unexpected movement of the clip that may injure the hand by hitting or pinching.
-  **Examine the strength of areas (the ceiling, floor, wall) where the camera-mount is to be installed.**
Prior to attaching the camera-mount to the ceiling, wall or floor, examine the strength of the area of installation. Insufficient support strength may cause the camera to accidentally drop leading to injury to persons nearby.
-  **Inspect the camera-mount regularly.**
Insufficient support strength due to erosion of bracket or screw may cause the camera to accidentally drop leading to injury to persons nearby. In addition, a crack in the clip may lead the clip to accidentally scatter broken pieces causing injury to persons nearby. In this case, please prohibit the use of the camera mount.
-  **Keep the camera-mount out of baby's reach.**
The clip may injure the hand of baby by pinching or the like. In addition, small accessories could choke or injure a baby if swallowed. Contact a doctor immediately if this happens.
-  **Do not modify the camera-mount.**
It may cause the camera to drop accidentally.

Caution

-  **Do not rub your hands along the edge of both the metal and plastic part.**
Rubbing with excessive force may cause injury to the hands.
-  **Do not clean the camera-mount with volatile solvents, such as thinner and benzene.**
This may damage or change the quality of the coating.
-  **Do not let children play with the empty carton or bag.**
It could choke or injure children.
-  **Hold the finger grip firmly when opening the clip.**
While opening the clip, do not release your hands from the finger grip as this may lead to the pinching of the finger causing injury.
-  **Do not move the clip when screws are tightly locked.**
The moving of the clip may lead to damage of the mount due to the excessive force of the locked screws.
-  **Be cautious when applying external force to the camera head as it may detach from the clip.**
This may lead the camera to drop and injure persons nearby.
-  **When attaching the camera-mount to a tripod, have caution in removing the camera head out of the clip.**
Attaching the camera-mount to a tripod before removing the camera head out of the clip may lead to the camera cable becoming stuck causing damage to the camera-mount and the camera-head due to excessive force.
-  **Do not place the camera-mount near excessive heat or strong sunlight.**
Excessive heat may cause the camera-mount to change shape causing the camera head to detach.
-  **Do not place the camera-mount in an area prone to heavy vibration.**
This may loosen the screws causing the camera head to detach.

How to use

1. Attach the flexible camera mount to a camera tripod or the like.

Before attaching, check if locking screw A is tightened.

- 1) Loosen locking screw (A. B).
- 2) Attach to a camera tripod or the like.

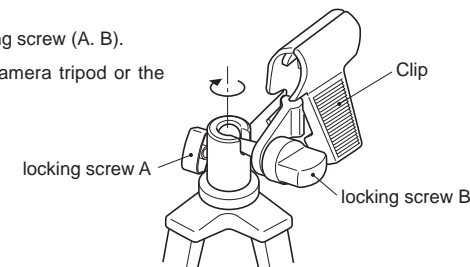

2. Adjust the position of the clip.

- 1) Loosen locking screw (A. B).
- 2) Determine the position of the clip.
- 3) Tighten locking screw (A. B).

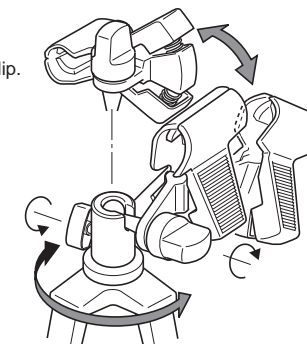

3. Attach camera head to the flexible camera mount.

Camera direction can be adjusted by loosening locking screw (A. B). (Make sure to tighten locking screw firmly after the adjustment.)

- 1) Attach camera head to the clip as shown in the picture.

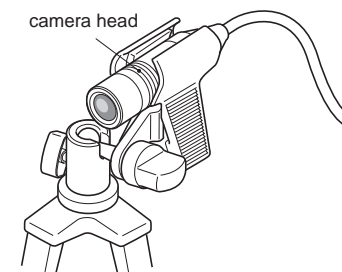

※ Refer to the instruction manual of individual equipment for actual shooting.

Applicable Cameras	: SUV-Cam · MN43H · MP50H · MN400 · MP450
Weight	: Approx. 100g